

# EPIC-SEC

EMORY PRACTICAL INTERVENTION COURSE SOUTHEASTERN CONSORTIUM

**MARCH 3-5, 2016**

Emory Conference Center Hotel - Atlanta, GA

RE: Invitation to Exhibit

On behalf of the EPIC-SEC conference committee, we are pleased to contact you regarding our upcoming program. This letter serves as an invitation to exhibit at the Emory Practical Intervention Course – Southeastern Consortium (EPIC-SEC), which takes place March 3-5, 2016 at the Emory Conference Center Hotel in Atlanta, Georgia.

Our attendees look forward to the opportunity to interact with our exhibitors. We anticipate an attendance of approximately 600 healthcare professionals. The consortium is designed for interventional cardiologists, cardiac and vascular surgeons, nurse practitioners, physician assistants, interventional radiologists and other healthcare professionals interested in the optimal practice of interventional, structural and peripheral cardiovascular medicine.

This year, we have added three more academic medical centers from the southeastern United States to join EPIC-SEC for a total of 15 medical centers participating in the clinical, education and research consortium. The EPIC SEC conference is the annual highlight of the consortium. These centers include: Emory University, Duke University, Medical University of South Carolina, Ochsner Health System, University of Alabama, University of Arkansas, University of Florida Health Jacksonville, University of North Carolina, University of Texas Health Science Center at San Antonio, University of Texas Health Science Center at Houston, University of Texas Southwestern Medical Center, University of Virginia, Vanderbilt University, Virginia Commonwealth University Health System and Wake Forest University.

Exhibit space is available for all three days of the conference. We are offering distinct levels of exhibitor packages, which include platinum, gold, silver and bronze. Please see the enclosed exhibit space application for details. Applications are due no later than Friday, January 22, 2016.

**To reserve your space today, email the completed application form to *Katlyn Cooper, Program Manager*, at [kcooper@achlcme.org](mailto:kcooper@achlcme.org) or via fax at 773-714-0707. Exhibit fee must be paid in advance in order to exhibit at the program. You may also contact Katlyn at 773-714-0705 ext. 203 with questions.**

We look forward to having you join us for EPIC-SEC 2016!

***Habib Samady, MD, FSCAI***  
Course Co-Director  
Emory University School of Medicine  
Atlanta, Georgia

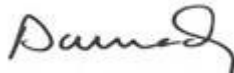

***Vasilis C. Babaliaros, MD***  
Course Co-Director  
Emory University School of Medicine  
Atlanta, Georgia



***Spencer B. King, III, MD, MACC***  
Course Co-Director  
Emory University School of Medicine  
Atlanta, Georgia



***John S. Douglas, Jr., MD, FSCAI***  
Course Co-Director  
Emory University School of Medicine  
Atlanta, Georgia



***Vinod Thourani, MD***  
Course Co-Director  
Emory University School of Medicine  
Atlanta, Georgia

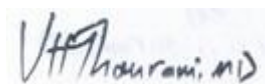

# EPIC-SEC

EMORY PRACTICAL INTERVENTION COURSE SOUTHEASTERN CONSORTIUM

## MARCH 3-5, 2016

Emory Conference Center Hotel - Atlanta, GA

### Exhibit Space Packages

Emory Practical Intervention Course – Southeastern Consortium (EPIC-SEC)  
March 3-5, 2016 • Emory Conference Center Hotel • Atlanta, Georgia  
<http://www.eccri.emory.edu/EPIC>

#### Platinum Package \$10,000

Booth locations near the Coronary Track and the Speaker Ready Room

Four attendees receive access to EPIC-SEC

Two attendees can participate in the Faculty Dinner

#### Gold Package \$7,500

Booth locations near the Coronary Track and Conference Registration

Three attendees receive access to EPIC-SEC

One attendee can participate in the Faculty Dinner

#### Silver Package \$5,000

Booth locations near the Structural & Peripheral Tracks

Two attendees receive access to EPIC-SEC

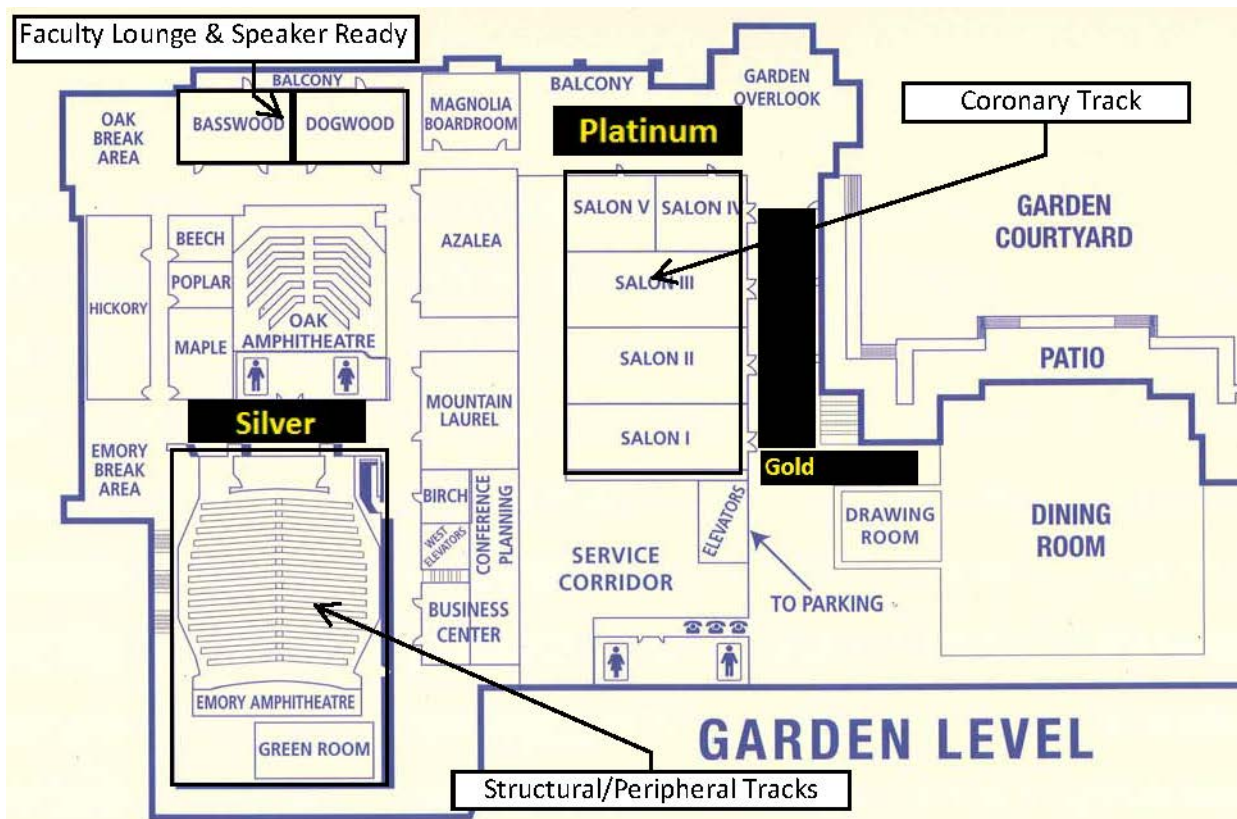

### Sponsorship Opportunities

Emory Practical Intervention Course – Southeastern Consortium (EPIC-SEC)

March 3-5, 2016 • Emory Conference Center Hotel • Atlanta, Georgia

<http://www.eccri.emory.edu/EPIC>

Product	Purpose	Impression	Cost
Print Ad in EPIC-SEC Final Program	The EPIC-SEC final program will feature the consortium agenda, faculty listing, special events, exhibitor and sponsor listings, and floor plans.	600 cardiovascular healthcare professionals	¼ page: \$1,500 ½ page: \$3,000 Full page: \$5,000
Conference Bag	EPIC-SEC attendees will receive a conference bag featuring your company identification. Promotion also includes one product or handout for inclusion in the bag.	600 cardiovascular healthcare professionals	\$8,000
Hotel Key Card Holders	Make a first impression with custom room key card holders for all EPIC-SEC attendees staying at the conference center hotel.	300 Emory Conference Center Hotel guests	\$1,500
Door Drop	Have your promotional materials delivered outside attendee hotel rooms on Thursday, Friday or Saturday morning. These items should be supplied by the sponsor and require approval of EPIC-SEC prior to printing.	300 Emory Conference Center Hotel guests	\$1,000
Bag Insert	Put your promotional materials in every attendee's hand. These items should be supplied by the sponsor and require approval of EPIC-SEC prior to printing.	600 cardiovascular healthcare professionals	\$1,000
Banners	As attendees move through the educational sessions, take advantage of this high-visibility opportunity with a banner lining the hallway or stairs.	600 cardiovascular healthcare professionals	Upon Request
Faculty Lounge	The faculty lounge at EPIC-SEC will provide a place for faculty to gather and refresh between presentations. Sponsorship will include signage, snacks and refreshments.	150 faculty	\$7,500
Breakfast, lunch or evening symposia	The symposia may be CME-certified or non-CME, single- or multi-supported. Symposia fee includes costs associated with the meeting space, inclusion on the conference agenda and audiovisual equipment.	150 cardiovascular healthcare professionals	\$7,000
Conference Lanyards	EPIC-SEC attendees will receive a lanyard with their name badge upon arriving to the conference. This sponsor can customize a promotional message for inclusion on the lanyard.	600 cardiovascular healthcare professionals	\$2,000
Stylus Pens	EPIC-SEC attendees will receive a stylus pen featuring your company identification. Attendees can use the product as a traditional writing utensil or as an instrument for touchscreen devices	600 cardiovascular healthcare professionals	\$1,000

# EPIC-SEC

EMORY PRACTICAL INTERVENTION COURSE SOUTHEASTERN CONSORTIUM

## MARCH 3-5, 2016

Emory Conference Center Hotel - Atlanta, GA

### Application for Exhibit Space – Part 1 of 3

Emory Practical Intervention Course – Southeastern Consortium (EPIC-SEC)

March 3-5, 2016 • Emory Conference Center Hotel • Atlanta, Georgia

<http://www.eccri.emory.edu/EPIC>

To reserve your space today, fax or e-mail your completed form to Katlyn Cooper, Program Manager, at 773-714-0707 or [kcooper@achlcme.org](mailto:kcooper@achlcme.org).

Name of Exhibiting Organization: \_\_\_\_\_

Address of Organization: \_\_\_\_\_

Name of Main Contact: \_\_\_\_\_

Business Telephone: \_\_\_\_\_ Email: \_\_\_\_\_

#### Levels of Exhibitor Participation:

Platinum (\$10,000)

Gold (\$7,500)

Silver (\$5,000)

Conference registration for additional representatives (Optional - \$500 per person)

\_\_\_\_\_ Reps at \$500 each = \$ \_\_\_\_\_

#### Sponsorship Opportunities (Optional)

Product #1 \_\_\_\_\_ \$ \_\_\_\_\_

Product #2 \_\_\_\_\_ \$ \_\_\_\_\_

Product #3 \_\_\_\_\_ \$ \_\_\_\_\_

*\*Sponsorship offerings are awarded on a first-come first-served basis and are not guaranteed.*

*\*Minimum exhibit purchase required to qualify for additional support opportunities.*

Total: \$ \_\_\_\_\_

### Application for Exhibit Space – Part 2 of 3

Emory Practical Intervention Course – Southeastern Consortium (EPIC-SEC)

March 3-5, 2016 • Emory Conference Center Hotel • Atlanta, Georgia

<http://www.eccri.emory.edu/EPIC>

1. Company \_\_\_\_\_

2. COMPANY REPRESENTATIVES AT EXHIBIT BOOTH:

(Four for Platinum, three for Gold, two for Silver and one for Bronze · Additional names are \$500 each)

PLEASE PRINT:

Name \_\_\_\_\_ Email \_\_\_\_\_

Name \_\_\_\_\_ Email \_\_\_\_\_

Name \_\_\_\_\_ Email \_\_\_\_\_

Name \_\_\_\_\_ Email \_\_\_\_\_

Name \_\_\_\_\_ Email \_\_\_\_\_

Name \_\_\_\_\_ Email \_\_\_\_\_

3. **PRODUCTS/MATERIAL TO BE EXHIBITED:** (i.e. Ablation catheters, promotional literature, surgical tools)

**SPECIAL SET-UP NEEDS:** Including telephone and electrical outlet access. (Note: Access to electrical outlets may be limited). Extra fees may apply – exhibitors will be contacted to discuss arrangements if applicable.

Number of Outlets \_\_\_\_\_ Wattage per Outlet \_\_\_\_\_

Other needs:

4. **Sign here to acknowledge the following statement:** We agree to abide by all requirements as outlined on this application and the prospectus. Proprietary company representatives may not engage in sales activities where the educational activity occurs.

\_\_\_\_\_  
Authorized Signature

\_\_\_\_\_  
Title

\_\_\_\_\_  
Date

# EPIC-SEC

EMORY PRACTICAL INTERVENTION COURSE SOUTHEASTERN CONSORTIUM

## MARCH 3-5, 2016

Emory Conference Center Hotel - Atlanta, GA

### Application for Exhibit Space – Part 3 of 3

Emory Practical Intervention Course – Southeastern Consortium (EPIC-SEC)  
March 3-5, 2016 • Emory Conference Center Hotel • Atlanta, Georgia  
<http://www.eccri.emory.edu/EPIC>

### PAYMENT DETAILS

**Please make all checks payable to:**

Emory University Hospital, Division of Cardiology  
ATTN: EPIC-SEC exhibits  
1364 Clifton Road, Suite F622  
Atlanta, GA 30322

Exhibit fee *must* be paid in advance in order to exhibit at the program. Confirmation will be sent to contact listed on application once payment is received.

Charge to credit card below      -OR-       Hold spot with credit card only until check arrives

MC/V/AE Number: \_\_\_\_\_ Exp. Date: \_\_\_\_\_ / \_\_\_\_\_

Name on card (print): \_\_\_\_\_ Security Code: \_\_\_\_\_

Address associated with card: \_\_\_\_\_

City: \_\_\_\_\_ State: \_\_\_\_\_ Zip: \_\_\_\_\_

Signature: \_\_\_\_\_

(Required if paying with credit card)

- Make your **Check** Payable to "Emory University Hospital, Division of Cardiology"
- Send check with a **COPY** of the Application Form
- Specify special set-up needs in exhibit space application. Extra fees may apply.



### EXHIBITOR POLICIES

#### EXHIBIT SPACE & LOGISTICS

Exhibit space assignments, hours of operation, set-up times, and shipping information will be communicated to approved exhibitors during the first week of February.

Exhibit space includes 1 - 6'30" table with linens and 2 chairs. Exhibit services not provided.

#### GENERAL CONDUCT

The following practices are prohibited:

- Use of volatile or flammable fluids, substances, or any materials prohibited by city fire regulations or insurance carriers.
- Use of noisy electrical or mechanical apparatuses interfering with other exhibitors.
- Canvassing or distributing any material outside the exhibitor's own space.
- Subleasing exhibit space.
- Use of billboard advertisement and/or display of signs outside of the exhibit area without prior approval.
- Failure to comply with fire restrictions; all aisles and exits should be kept clear, clean and free from obstructions.

#### LIABILITY

It is agreed that individual exhibitors will protect, save and keep the Emory Practical Intervention Course – Southeastern Consortium (EPIC-SEC) from any damage or charges imposed for violation of any law or ordinance whether occasioned by the negligence of the exhibitor or those holding under the exhibitor, and will strictly comply with the applicable terms regarding the exhibition premises. Further, the exhibitor shall at all times protect, indemnify, save and keep harmless the above parties against and from any and all loss, cost, damage, liability, or expenses arising from or out of or by reason of any accident or other occurrence to anyone, including the exhibitor, its agents, employees and business invitees, which arise from or out of or by reason of said exhibitor's occupancy and use of the exhibition premises or a part thereof.

#### INSURANCE

Exhibitors are urged to take out a portal-to-portal rider, which is available at a nominal cost on their own insurance policy to protect them against loss through theft, fire, damage, etc.

#### APPLICATION DEADLINE

Exhibit and promotional applications are due Friday, January 22, 2016.

